

T-12W-12V-PI

T-FPC  
(included)

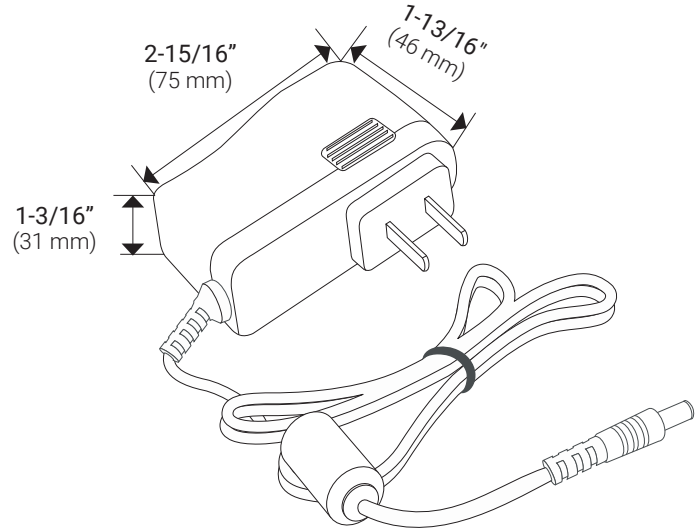

## 12 WATT PLUG-IN POWER SUPPLY

PART NUMBER	DESCRIPTION	DIMENSIONS	AC POWER CORD LENGTH	VOLTS	AMPS
T-12W-12V-PI	12 watt AC/DC 2 prong plug-in, 12 volt DC 1 AMP	2-15/16" x 1-3/16" x 1-13/16" 74.61 mm x 30.61 mm x 46.04 mm	56" (4 ft. 8") 1422.4 mm	12	1

## FEATURES

- No hardwiring required – use an existing hidden outlet
- Easily extend wire between fixture and power supply with Female Barrel Connector (T-FBC)
- Dims on the 12-volt or secondary side with switches, sensors, or the Wireless Dimming System
- 12-volt power supplies over 60 watts are UL Listed for commercial use, and are not UL Class 2 Listed for residential
- 3-year limited warranty
- Designed for indoor application

## TECHNICAL INFORMATION

<b>Series</b>	Plug-in Power Supply Series
<b>Input Voltage</b>	120 volt AC
<b>Output Voltage</b>	12-volt DC
<b>Output Wattage</b>	12 watts
<b>Dimmable</b>	Non-dimmable
<b>Rating</b>	cULus Listed
<b>Rated Life</b>	30,000 hrs
<b>Mounting</b>	Free placement
<b>Operating Temperature</b>	32°F to 104°F (0°C to 40°C)
<b>Environment</b>	Dry location
<b>Construction Material</b>	Plastic housing
<b>Warranty</b>	3 years

## INSTALLATION LOCATIONS

- Above Cabinet / Open Soffits
- Interior Wall Cabinet
- Base Cabinets
- Open Coves
- Any Available & Accessible Outlets

**DO NOT INSTALL IN AN ATTIC**